



# NASBA 2014 *Eastern & Western Regional Meetings*

## AGENDA

### 2014 WESTERN REGIONAL MEETING

### JUNE 10-13, ST. LOUIS, MISSOURI

#### TUESDAY

6:00 - 8:00 p.m.      New Accountancy Board Member Reception      *Park View*

#### WEDNESDAY

7:30 – 8:30 a.m.      New Accountancy Board Member Breakfast      *Sterling 3*

8:30 a.m. – 2:30 p.m.      New Accountancy Board Member Orientation Program      *Regency AB*

4:00 – 5:00 p.m.      Regional Meeting Registration      *Regency Foyer*

6:00 – 8:00 p.m.      Welcome Reception      *Gateway East/West Terrace*

#### THURSDAY

8:00 – 9:00 a.m.      BREAKFAST (All Welcome)      *Park View*

9:00 – 9:20 a.m.      Welcome from Regional Directors (All Regions)      *Regency CD*

9:20 – 9:30 a.m.      Welcome from Host Board  
**Robert Helm, Missouri State Board of Accountancy**      *Regency CD*

9:30 – 10:00 a.m.      Update from NASBA Leadership  
**Carlos E. Johnson and Ken L. Bishop**      *Regency CD*

10:00 – 10:30 a.m.      Changes in Compilation Standards  
**Janice L. Gray and Chas McElroy**      *Regency CD*

10:30 -10:45 a.m.      BREAK      *Regency Foyer*

10:45 – 11:15 a.m.      Uniform Accountancy Act Issues  
**Kenneth R. Odom and Noel L. Allen**      *Regency CD*



## THURSDAY (continued)

- |                    |  |            |
|--------------------|--|------------|
| 11:25 – 12:25 p.m. | <p>Leadership Presentation - Questions and Answers<br/> <b>(Carlos E. Johnson, Ken L. Bishop, Colleen K. Conrad, Walter C. Davenport, Gaylen R. Hansen)</b><br/> <b>2 Regions Meet – Regional Directors moderate with topic experts present.</b><br/> <b>Southwest and Central – Regency AB</b><br/> <b>Pacific and Mountain – Regency EF</b></p> <p><i>(Participation limited to Board of Accountancy members, staff and former Board of Accountancy members)</i></p>   |            |
| 11:25 – 12:25 p.m. | <p>Seminar for Those Not Affiliated with a Board: Working Together to Strengthen Accounting Education<br/> <b>James Suh and Ryan Hirsch</b></p>  | Grand AB   |
| 12:30 – 1:30 p.m.  | <p>LUNCH (All Meeting Attendees – Table Topics)<br/> <i>Assigned seating</i></p>   | Park View  |
| 1:35 - 2:20 p.m.   | <p>The Future of Practice Monitoring<br/> <b>Susan S. Coffey and G. Alan Long</b></p>  | Regency CD |
| 2:25 – 4:05 p.m.   | <p>Meet with Your Region<br/> <b>Pacific: Raymond N. Johnson – Regency A</b><br/> <i>(Substituting for Pacific Regional Director Donald F. Aubrey, CPA)</i><br/> <b>Southwest: A. Carlos Barrera – Regency B</b><br/> <b>Central: Douglas W. Skiles – Regency E</b><br/> <b>Mountain: Richard N. Reisig – Regency F</b><br/> <i>(Participation limited to Board of Accountancy members, staff and former Board of Accountancy members. Each Region will meet in a separate room with the Regional Director leading the discussion. Election of Nominating Committee Representatives in Pacific and Central Regions.)</i></p> |            |
| 2:25 – 3:25 p.m.   | <p>Seminar for Those Not Affiliated with a Board: Overcoming Barriers Through Collaboration<br/> <b>John Johnson</b></p>   | Grand D    |
| 4:15– 4:30 p.m.    | <p>Raffle – Part I</p>   | Regency CD |



## FRIDAY

7:30 – 8:50 a.m.	Board of Accountancy Chairs’ and Presidents’ Breakfast Meeting	<i>Sterling 3</i>
7:30 – 8:50 a.m.	Board of Accountancy Executive Directors’ Breakfast Meeting	<i>Sterling 4</i>
8:00 – 9:00 a.m.	BREAKFAST (All Welcome)	<i>Park View</i>
9:00 – 9:15 a.m.	Report from Regional Breakouts (A summation of Thursday’s sessions) <b>Panel of All Western Regional Directors</b>	<i>Regency CD</i>
9:15 – 9:45 a.m.	Legal Heads Up <b>Noel L. Allen</b>	<i>Regency CD</i>
9:45 - 10:00 a.m.	Bringing More Diversity into Boards of Accountancy <b>Leonard R. Sanchez</b>	<i>Regency CD</i>
10:00 – 10:15 a.m.	Education: Implementing the Pathways Project <b>Melanie G. Thompson</b>	<i>Regency CD</i>
10:15 - 10:30 a.m.	The Future of Learning Is Here <b>Maria Caldwell</b>	<i>Regency CD</i>
10:30 - 10:45 a.m.	BREAK	<i>Regency Foyer</i>
10:45 – Noon	Breakout Sessions (Select one)	
	1. Strategies for Promoting a Diverse Board <b>Leonard R. Sanchez and Edwin F. Barnicott</b>	<i>Regency A</i>
	2. New Learning Methods and CPE Standards Changes <b>Maria Caldwell, Jessica Luttrull and Rita Sehgal</b>	<i>Regency B</i>
	3. Focus on Standard Setting <b>Gaylen R. Hansen</b>	<i>Regency E</i>
	4. Applying the Ethics Codification in Your State <b>Raymond N. Johnson</b>	<i>Regency F</i>
Noon – 1:00 p.m.	Board Communications Lunch Meeting	<i>Sterling 7</i>
Noon – 1:00 p.m.	LUNCH (Meeting Attendees Only)	<i>Park View</i>
1:00 – 2:15 p.m.	Breakout Sessions (rooms same as above) <i>(Select one from breakouts listed for morning. Participants asked to select different session from one attended earlier.)</i>	
2:15 – 2:30 p.m.	BREAK	<i>Regency Foyer</i>



## FRIDAY (continued)

2:30 – 3:00 p.m.	<p>Summary of NASBA Education Research Projects  <b>Panel Moderator – John E. Peterson</b>  <b>Panelists - Dennis Bline, H. Fred Mittelstaedt and Bradley Steven Trinkle</b></p>	<i>Regency CD</i>
3:00 – 3:15 p.m.	<p>Report from the CPA Examination Review Board  <b>Ronald E. Nielsen</b></p>	<i>Regency CD</i>
3:15 – 4:00 p.m.	<p>The Uniform CPA Examination</p> <ul style="list-style-type: none"> <li>• Report from the Board of Examiners- Practice Analysis Begins  <b>Frederick Niswander</b></li> <li>• Report on International Administration of the CPA Examination  <b>Colleen K. Conrad</b></li> </ul>	<i>Regency CD</i>
4:00 – 4:15 p.m.	<p>Questions and Answers for NASBA  <b>Carlos E. Johnson and Ken L. Bishop</b></p>	<i>Regency CD</i>
4:15 – 4:30 p.m.	<p>Raffle Drawing – Part II</p>	<i>Regency CD</i>
6:30 p.m.	<p>Gala</p>	



**FLOOR PLAN**  
*Second Floor*

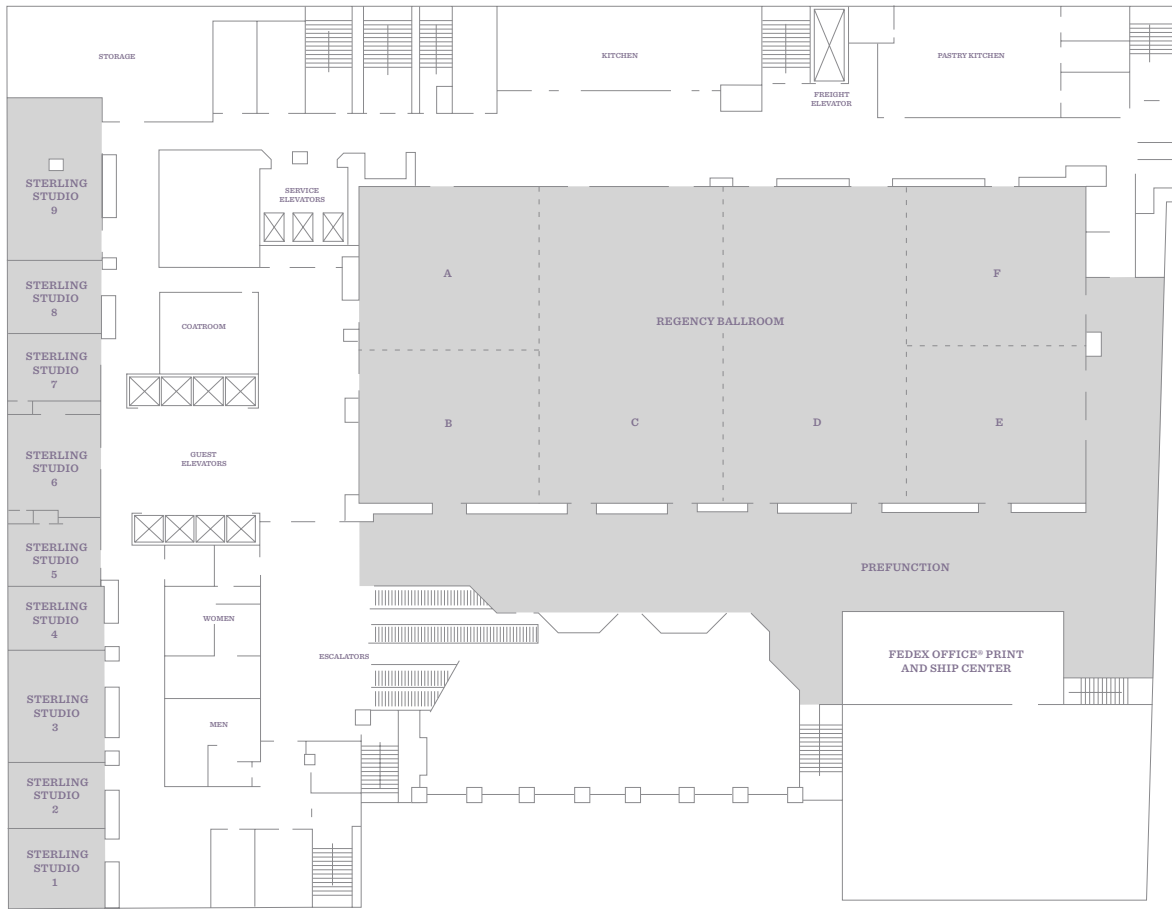



# NASBA 2014 *Eastern & Western Regional Meetings*

**FLOOR PLAN**  
*Fourth Floor*

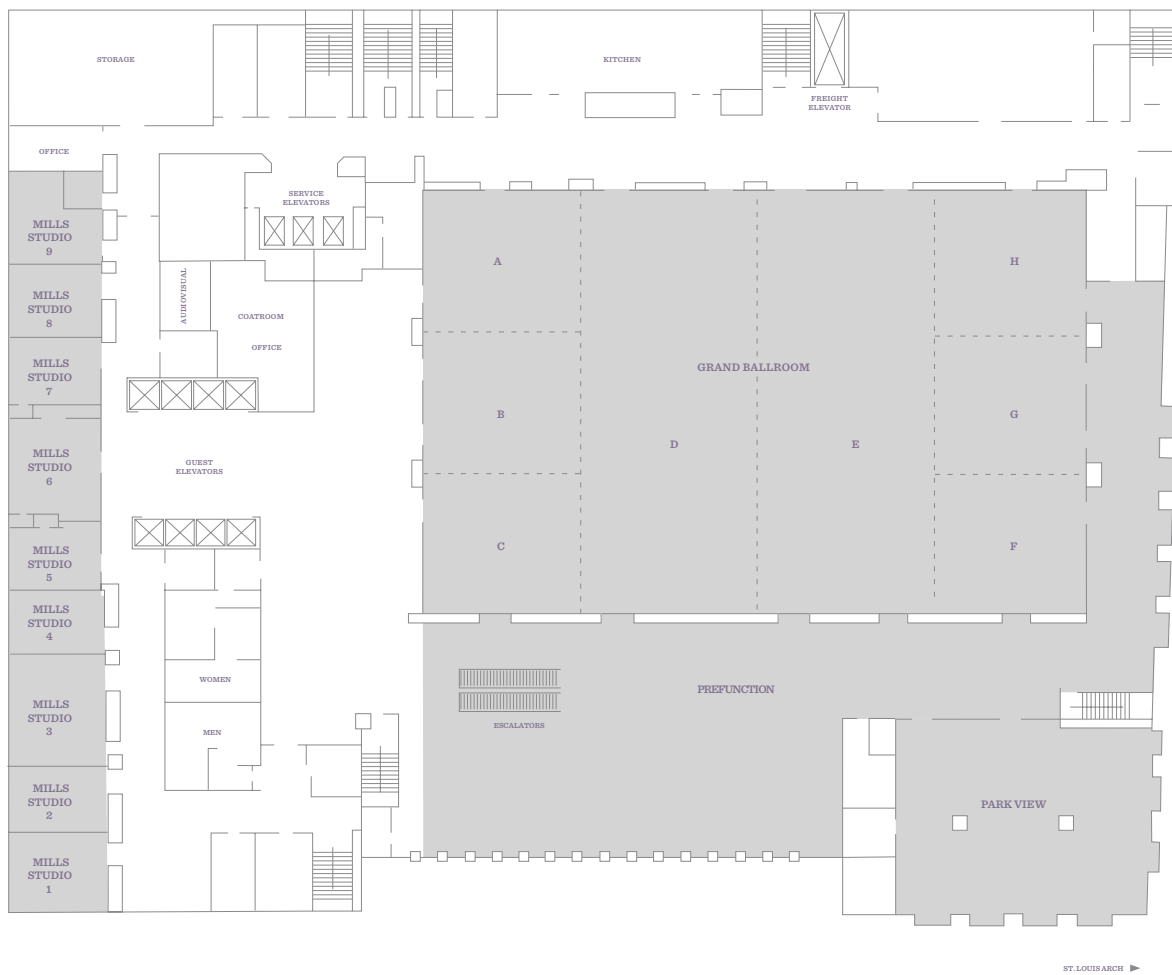



**FLOOR PLAN**  
*Eighteenth Floor*

